

# Mounting the mimio eraser and styli

- Install batteries in the mimio eraser and in each mimio stylus, Fig I
- Insert Expo® Dry Erase Markers according to the colour of the stylus, Fig J

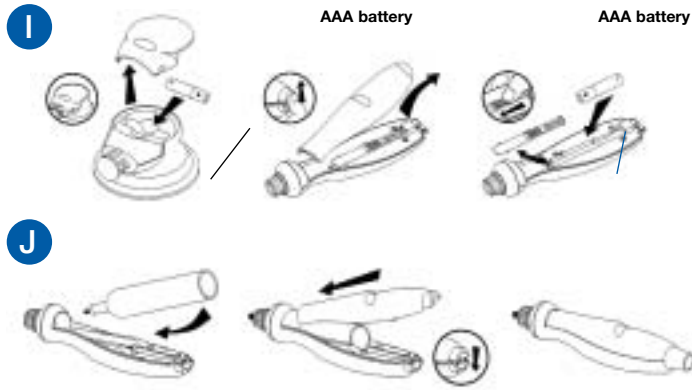

## Install the software

- Insert CD into CD-Rom drive
- Loads automatically
- If CD fails to load, click: >Start >Run >Browse >Choose CD Drive >Set up.exe >OK

Sahara Presentation Systems PLC  
Williams House, Hailey Road, Erith Kent DA18 4AA England  
[www.cleverboard.com](http://www.cleverboard.com)  
CleverBOARD Helpline: 020 8319 7788

mimio is a registered trademark of Virtual Ink Corporation.  
CleverBOARD is a registered trademark of Sahara Presentation Systems PLC.

**cleverboard<sup>2</sup>**  
using mimio® technology & incorporating lynx software

**cleverboard<sup>2</sup>**<sup>TM</sup>

INSTALLATION GUIDE using mimio® technology & incorporating lynx software

## Mounting the Cleverboard

- Pencil mark the top and bottom of the CleverBOARD as desired on wall, Fig A
- Fix brackets as shown in Figs B and C
- Lift CleverBOARD onto lower brackets, Fig D
- Push the top of the board towards the wall until it is vertical as in Fig D
- The push down top brackets until they 'click' onto the top of the board, Fig E
- The CleverBOARD is now securely wall mounted

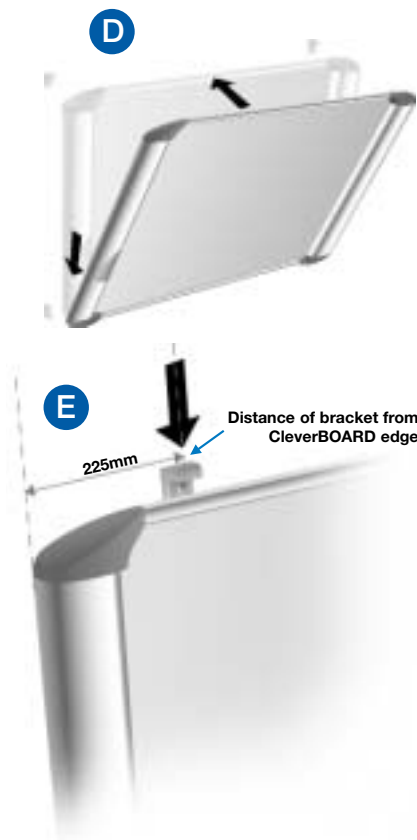
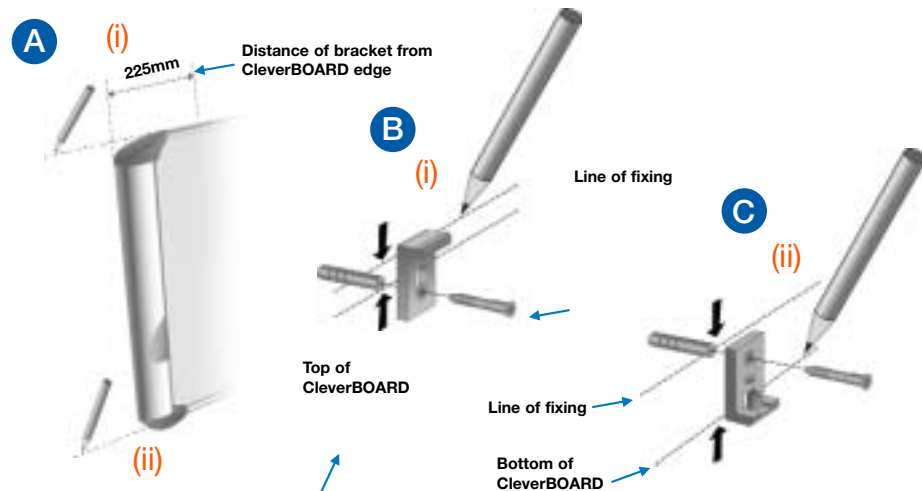

## Dismounting Cleverboard

- Push a flathead screwdriver under the top brackets and turn clockwise as shown in Figs F and G

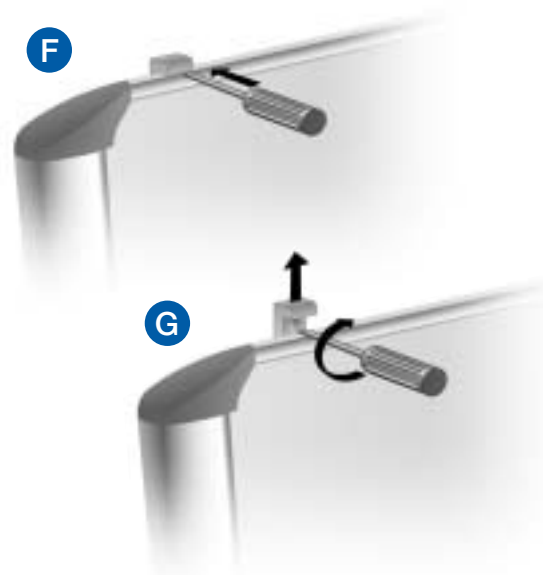

## Connecting the Cable

- Shut down your PC/Mac and make sure the power is off
- Disconnect your keyboard from the keyboard port
- Connect the mimio cable as shown in Fig H

